

ACEST DOCUMENT ESTE PROPRIETATEA SOCIETĂȚII ELLIS'92 S.R.L. - PLOIEȘTI. ÎN CONSECINȚĂ, FIRMA ARE DREPTUL EXCLUSIV DE FOLOSIRE A DESENULUI SAU DE OPERARE A EVENTUALELOR MODIFICĂRI DIN CÂMPUL ACESTUIA.

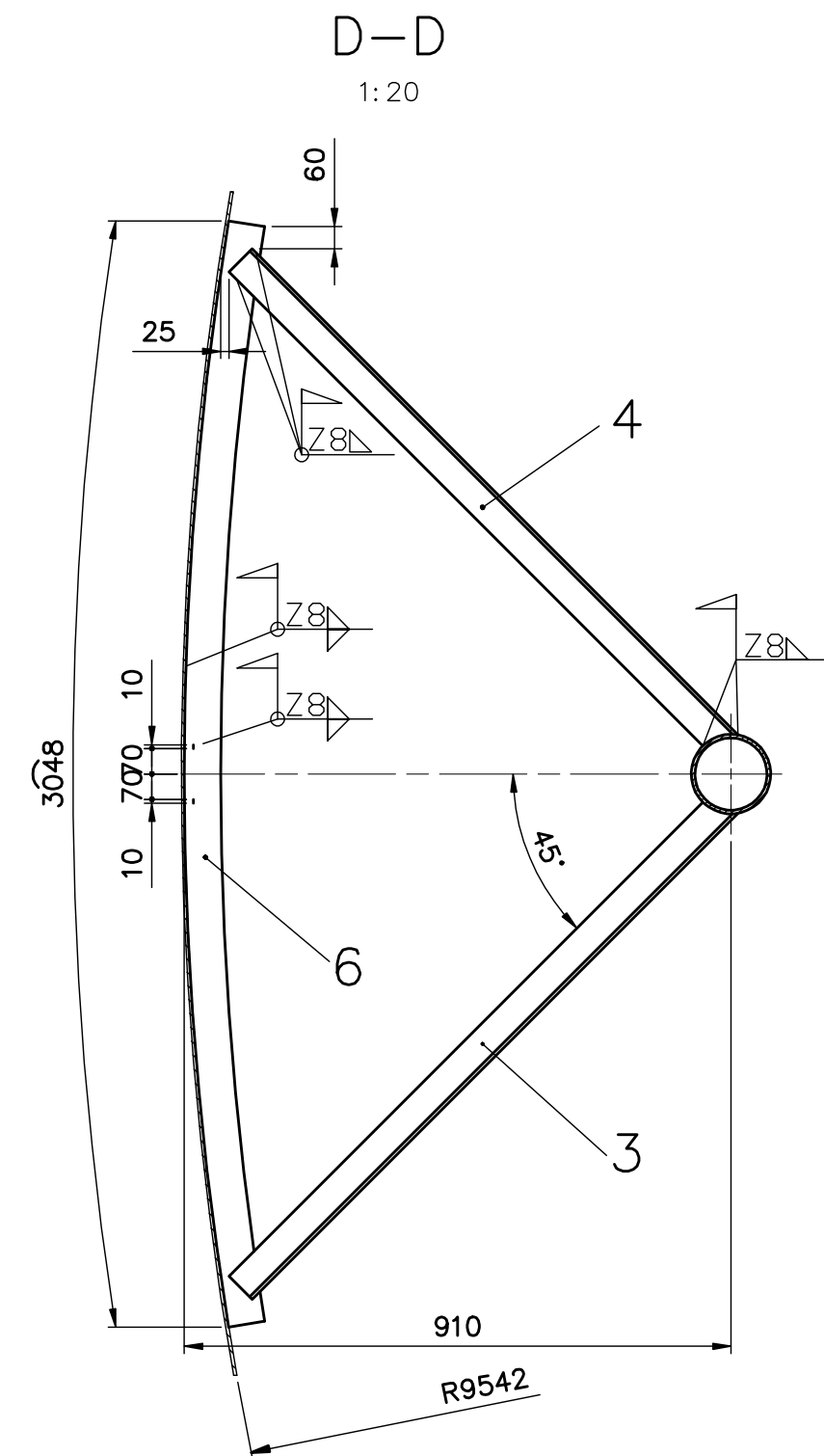
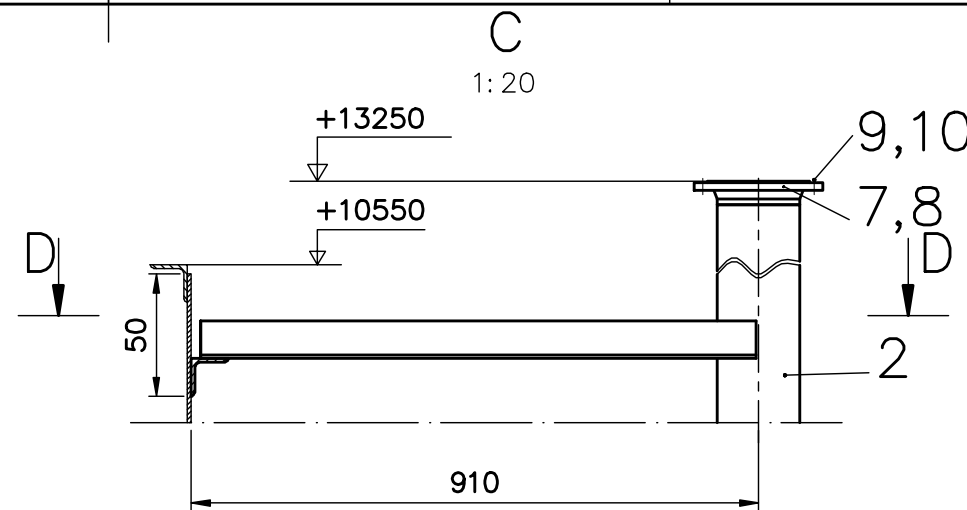
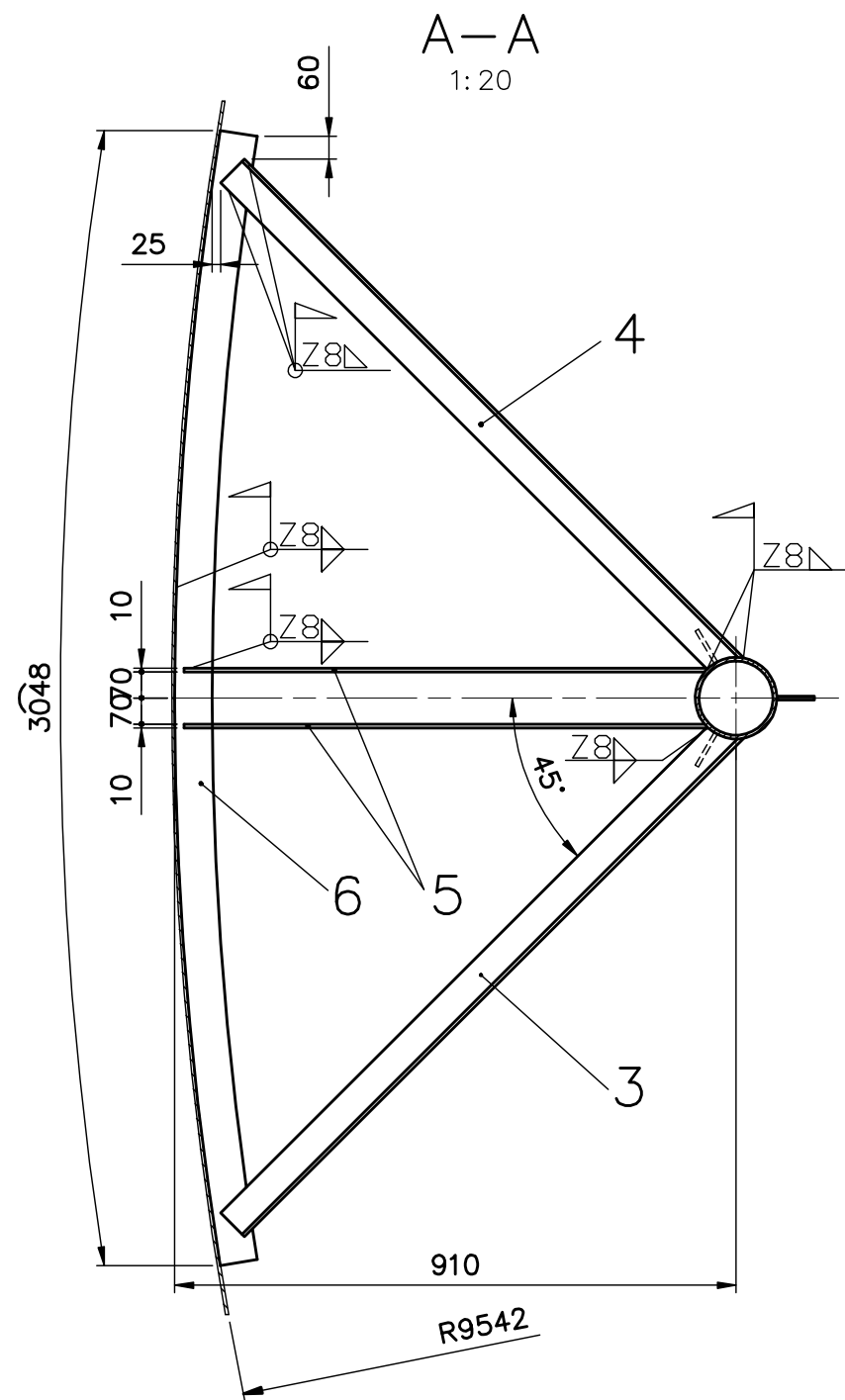
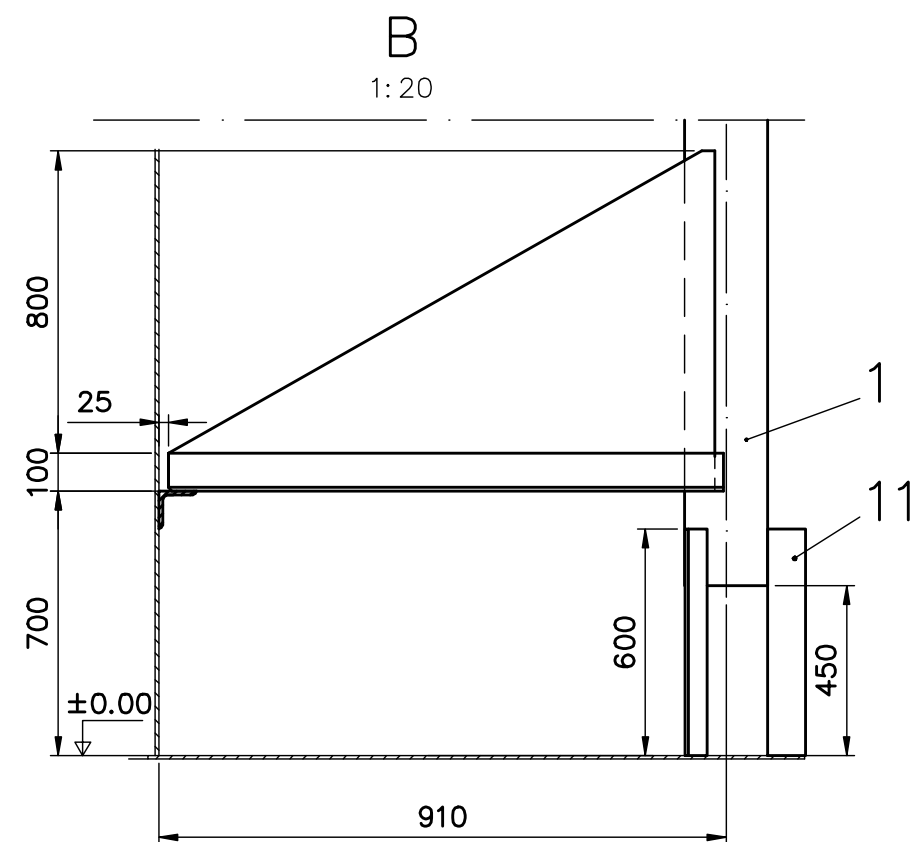
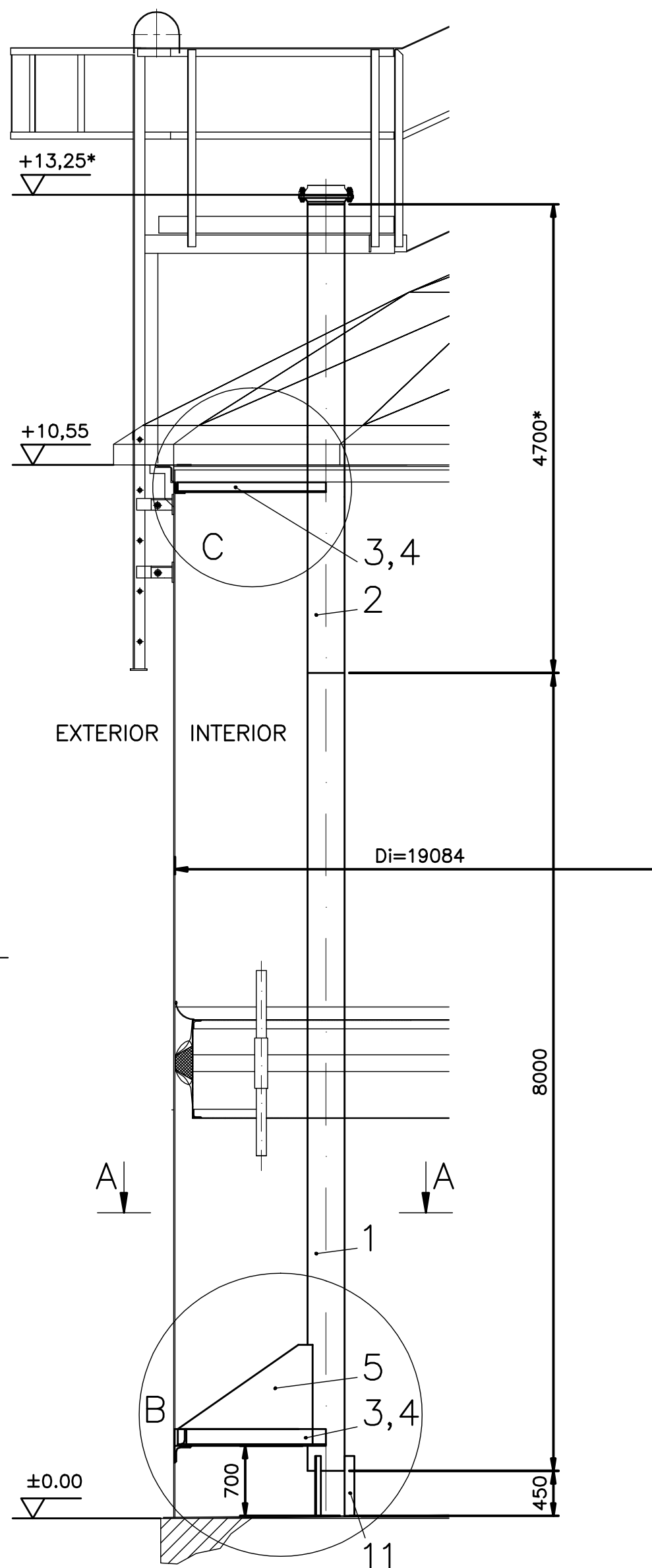

### NOTA

1. Pentru pozitia racordului pe dom, vezi desen A614U-00
2. Cota notata cu (\*) se definitiveaza dupa achizitionarea domului.

|   |   |                     |            |   |   |                  |             |
|---|---|---------------------|------------|---|---|------------------|-------------|
| 11  | Distanțier                                  |                     | 3          | S235J2<br>SR EN 10025-2:2004                | Ib.100x600x10   | 4,71             |             |
| 10  | Piulita stil 2                              |                     | 16         |   |   | 0,0603           |             |
| 9   | Prezon M20x140, tip1B                       |                     | 8          |   |   | 0,345            |             |
| 8   | Garnitura                                   |                     | 1          |   |   | 0.525            |             |
| 7   | Flansa racordare DN200,<br>tip 11, RF, PN16 |                     | 1          | P280GH<br>SR EN 10222-2                     |   | 11               |             |
| 6   | Cornier                                     |                     | 2          | S235J2<br>SR EN 10025-2:2004                | L100x100x10-3048  | 45,72            |             |
| 5   | Rigidizare                                  |                     | 2          | S235J2<br>SR EN 10025-2:2004                | Ib.1400x800x8   | 70,34            |             |
| 4   | Rigidizare                                  |                     | 2          | S235J2<br>SR EN 10025-2:2004                | L80x80x8-1880   | 18,10            |             |
| 3   | Rigidizare                                  |                     | 2          | S235J2<br>SR EN 10025-2:2004                | L80x80x8-1880   | 18,10            |             |
| 2   | Element stalp 2                             | A614U-09.01         | 1          | S235J2<br>SR EN 10025-2:2004                | Iv.ø219x10-4700   | 252,70           |             |
| 1   | Element stalp 1                             | A614U-09.01         | 1          | S235J2<br>SR EN 10025-2:2004                | Iv.ø219x10-8000   | 430,30           |             |
|   | Electrozi                                   | SR EN ISO 2560:2010 | -          |   |   | 30               |             |
| Poz.  | Denumirea                                   | Nr.desen sau STAS   | Buc        | Material                                    | Observatii  | Masa<br>kg/buc   |             |
| 3   |   |                     | 6          |   |   |                  |             |
| 2   |   |                     | 5          |   |   |                  |             |
| 1   |   |                     | 4          |   |   |                  |             |
| Rev.  | Descriere                                   | Data                | Semnat     | Rev.  | Descriere   | Data             | Semnat      |
| Acest document este proprietatea S.C. ELLIS'92 S.R.L. si nu va fi comunicat fara autorizare |   |                     |            |   |   |                  |             |
| Intocmit  | Verificat                                   | Aprobat             | Beneficiar |   | Denumire proiect  |                  |             |
| S.B.  | N.R.  | A.I.                | CONPET SA  |   | DEZAFECTARE REZERVOR R9 TITEI (V=2889 mc)<br>CONSTRUCTIE REZERVOR NOU PENTRU TITEI (V=2500 mc)<br>STATIA DE POMPARE CARTOJANI |                  |             |
|   |   |                     |            | TEAVA PENTRU GURA<br>DE LUAT PROBE<br>-GLP- |   | Nr.: A614U-09.00 |             |
|   |   |                     |            |   |   | Scara:1:100      |             |
|   |   |                     |            |   |   | Index:A614U-BD   |             |
|   |   |                     |            |   |   | Data: 04.2017    | Plansa: 1/1 |
|   |   | Material:           |            | Masa:1038 kg                                |   |                  |             |
| A2 (420x594)  |   |                     |            |   |   |                  |             |